

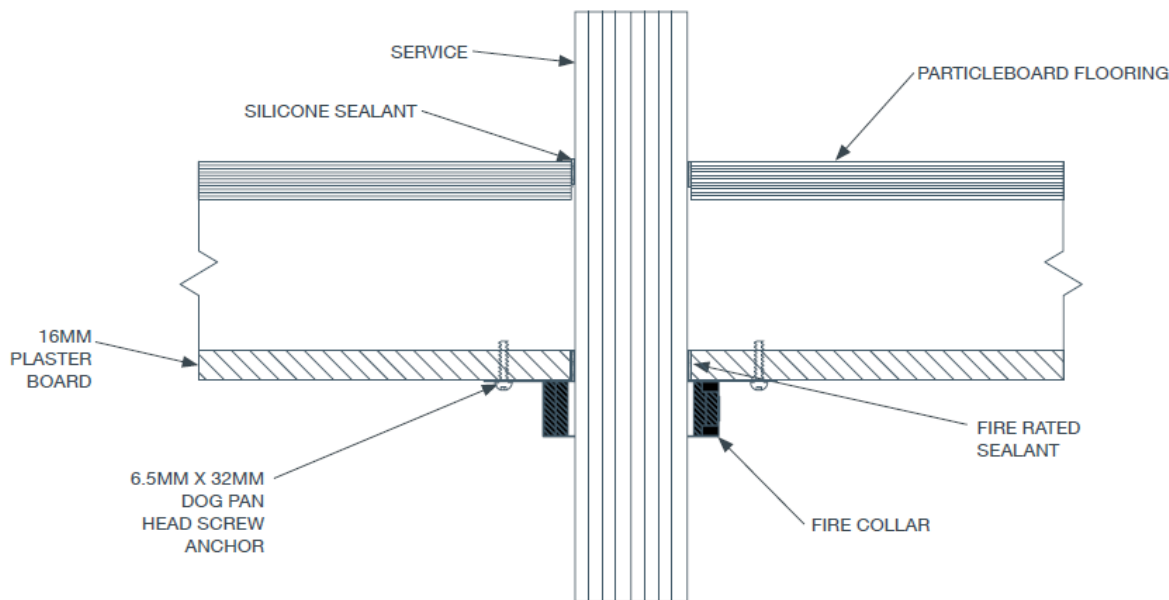

System FC499

Penetration Detail: Electric Cables
(TPS & CAT6) fire-stopped with
Allproof Low Profile Fire Collar

Separating Element: Min. 225mm thick
Ceiling Structure 1 x 16mm FR
Plasterboard



ALLPROOF
INDUSTRIES

Installation Instructions:

1. Ensure substrate around the services is flat and free from obstructions.
2. Seal the gap between the plasterboard and services with MAS310 to the full depth of the plasterboard.
3. Apply silicone sealant between the services and particleboard flooring on the unexposed face.
4. Open the collar and position it around the service penetration.
5. Slide the tab through the slot and fold it back to lock.
6. Secure collar using 6.5mmx32mm Dog Pan Head Screws. Do not use plastic or nylon-based fixings.

Services & Ratings (FRR)

Service Penetration	Service Size	Penetration Hole Size	Fire Collar Size	FRR
TPS cable	7x cables	32mm	ALLFC25	-/60/60
CAT6 cable	10x cables	28mm	ALLFC25	-/60/60

Compliance

Compliance BRANZ Appraisal No.
1088(2025)
Standards AS1530.4-2014 &
AS4072.1-2005

Firestop Centre Technical Support:
Tel: +64 9 483 4000
info@firestopcentre.co.nz
www.firestopcentre.co.nz

Drawing Rev: 1.1

Scale: NTS

Disclaimer: Firestop Centre may change product specifications without notice as part of our ongoing development and testing. All information in this document is provided in good faith and for guidance only. All drawings are for illustration purposes only and may not reflect the actual product. Since we cannot control how the product is installed or the conditions on-site, we do not guarantee the product's performance. We also accept no responsibility for any loss, damage, or injury resulting from the use of this information.